

## FACT SHEET for 2026/2027

### General Information of the Institution

<b>Name</b>	Seoul National University of Science and Technology (SeoulTech) Office of International Affairs
<b>Website</b>	www.seoultech.ac.kr

### Office of International Affairs

<b>Website</b>	<a href="https://irt.seoultech.ac.kr/">https://irt.seoultech.ac.kr/</a>
<b>Email</b>	exchange_seoultech@seoultech.ac.kr
<b>Address</b>	#115 International Hall (Bldg.38), SeoulTech, 232 Gongneung-ro, Nowon-gu, 01811, Seoul, Republic of Korea
<b>Tel</b>	(Incoming) +82-2-970-9216 / (Outgoing) +82-2-970-9214

### Academic Calendar

<b>Fall Semester 2026</b>	1. Sep. – 21. Dec, 2026
<b>Spring Semester 2027</b>	2. Mar. – 22. Jun, 2027 (Tentive)
<b>Fall Semester 2027</b>	1. Sep. – 21. Dec, 2027 (Tentive)

### Courses

\* **Course List:** <https://irt.seoultech.ac.kr/>

The finalized list of courses offered in English for each semester will be available one month before the start of the semester. In the meantime, please refer to the course list from the previous year. Please note that exchange students are allowed to select courses only from the Module list.

#### \* Syllabus

For students' convenience, we have gathered all the syllabi for the Module courses on Google Drive.

- (2026 Spring Semester) <https://drive.google.com/drive/folders/1pUOZuQxGcJMIhgKEX0tN1phAWr7EVID?usp=sharing>
- (2025 Fall Semester) <https://drive.google.com/drive/folders/1pUOZuQxGcJMIhgKEX0tN1phAWr7EVID?usp=sharing>

*The course list for each semester at SeoulTech is announced approximately six weeks before the start of the semester. Students may refer to the previous year's course list when considering whether to apply to SeoulTech. However, please note that some courses may be added or removed for the upcoming semester.*

*As course offerings are relatively flexible, students whose home universities have strict academic requirements—such as specific courses that must be taken—should be aware that SeoulTech cannot guarantee the availability of particular courses. Since course offerings may change, students are advised to take this into consideration when applying.*

### Intensive Korean Language Course Program (<https://klc.seoultech.ac.kr/en/course/registration/>)

Exchange students may enroll in an intensive Korean language course. This is a non-credit course, and students are required to pay the tuition fee.

### Grading System

All exchange students can take 2 credits ~ 18 credits per semester.

1 Credit = 16 teaching hours including lectures, exam, assignments, and attendance

1 Course = 2 or 3 credits

Each course lasts a semester(16 weeks).

ECTS Conversion Table	
SEOULTECH Credit	ECTS
1 credit	2 ECTS
2 credits	4 ECTS
3 credits	6 ECTS
4 credits	8 ECTS
5 credits	10 ECTS
6 credits	12 ECTS

### Assessment

Letter	Percent	Grade point
A+	4.5	100~95 %
A0	4.0	90~94%
B+	3.5	89~85%
B0	3.0	84~80%
C+	2.5	79~75%
C0	2.0	74~70%
D+	1.5	69~65%
D0	1.0	64~60%
F	0.0	50%
S	Satisfactory	
U	Unsatisfactory	

※ The lowest passing grade is D0(60.)

### Living in SEOULTECH

#### ■ On campus

SeoulTech guarantees accommodation in the Sunglim Dormitory for exchange students.

Please note that there are very limited spaces available in the International Hall. In addition, current residents are given priority to remain in the same room for the following semester. Therefore, the chances of being assigned to the International Hall are very low.

For this reason, we only accept applications for the International Hall on a waiting list basis. While accommodation in the Sunglim Dormitory is guaranteed, **placement in the International Hall is NOT guaranteed.**

ECTS Conversion Table		
Sunglim International Hall	Single room	Kitchen in the room
Sunglim Female/ Male Dormitory	Double room for Female student	Shared kitchen available
	Triple room for Male student	

**<Architecture Plan>**

- Sunglim Male Room(Triple room type) / Room 2
- Two male students occupy for room 2

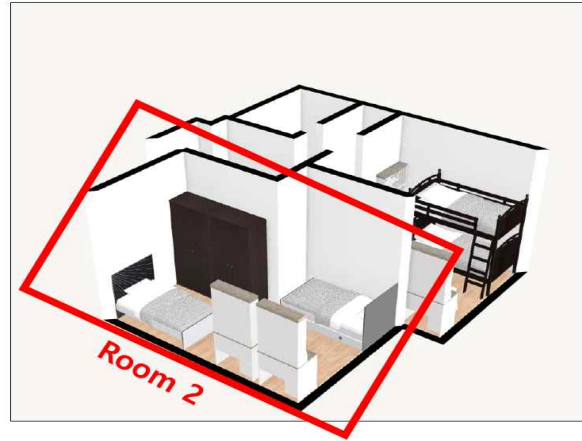

**<Architecture Plan>**

- Sunglim Male Room(Triple room type) / Room 1
- One male student occupies for room 1

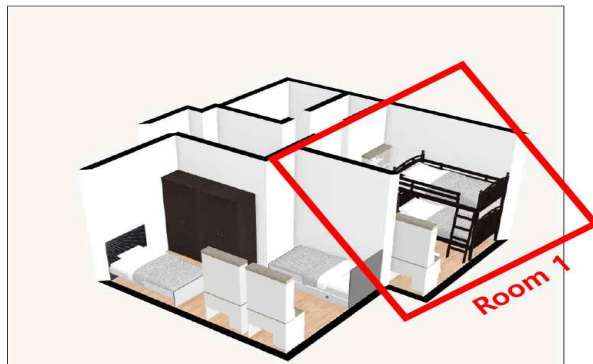
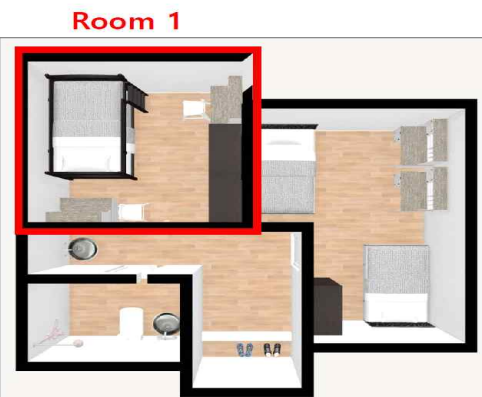

**<Architecture Plan>**

- Sunglim Female Room(Double room type)
- Two female students occupy for one room



\* Housing Fee

Dormitory Building and Room Type	Total Price for Whole semester
Sunglim Male's Dormitory (Two separate rooms: 2 beds(Room2) + 1 bed(Room1)) * 3 male students will share one room, no kitchen in the room.	(2 beds room) KRW 882,000 (1 bed room) KRW 1,120,350
Sunglim Female's Dormitory (One room: 2 beds) * 2 Female students will share one room, no kitchen in the room.	(2 beds room) KRW 896,760

\* The housing fee is subject to change

\* Meal Fee

Options	Meal	Total Price for 4 months
No meals	-	-
1 Meal (a day)	Breakfast	KRW 464,600
	Lunch	
	Dinner	
2 Meals (a day)	Breakfast & Lunch	KRW 808,000
	Lunch & Dinner	
	Breakfast & Dinner	
3 Meals (a day)	Breakfast& Lunch& Dinner	KRW 1,151,400

\* Housing Fee and Meal fee are subject to change.

■ Off campus

\* Blessing in Seoul : <https://blessing-in.seoulhotelspage.com/en/>

\* Stay14 : [www.stay14.com](http://www.stay14.com)

\* Goshipages : <https://goshipages.com/ko>

\* Borderless House: <https://www.borderless-house.com/kr/>

\* Ziptoss: <https://global.ziptoss.com/en/>

- SeoulTech does not collaborate with any private housing companies. However, housing information is provided solely for students' convenience. Please note that if any dispute arises between a housing provider and a student, the University will not assume any responsibility.

\* [enkostay: https://stay.enko.kr/](https://stay.enko.kr/)

**Number of exchanges students**

Due to accommodation capacity and course registration constraints, SeoulTech has implemented a strategic enrollment limitation starting from the 2024 academic year. This decision reflects our commitment to maintaining high standards of education, fostering a conducive learning environment, and ensuring that each student receives personalized attention and support.

**We will strive to maintain a balanced number of inbound and outbound exchange students.** If no SeoulTech students have participated in your exchange program during the past two semesters,

only one open seat will be allocated to your university.

Please note that we are unable to accept more than two students from each partner university per semester. **If there is any uncertainty regarding the quota, we strongly recommend contacting SeoulTech in advance before beginning your selection process.**

### Application procedure

#### ■ Nomination deadline (Online Application) \*subject to change

- Spring semester(Mar to Jun): **15th October** / Fall semester(Sep to Dec): **15th April**

#### ■ Application deadline (Online Application) \*subject to change

- Spring semester(Mar to Jun): **31st October** / Fall semester(Sep to Dec): **30th April**

#### ■ Application documents

- 1st: A copy of passport, Study Plan, Recommendation Letter, Official transcript
- 2nd: Health clearance(TB test result, Measles Vaccination Certificate), Flight info, Copy of Korea visa

#### ★ Additional documents (applicable only to students from non-OECD countries)

1. A **bank statement** showing the account balance
2. A **certificate of enrollment** from the current home university, notarized by the Korean Embassy or apostilled

\*\* Please note that the classification of non-OECD countries is determined based on the student's nationality(passport), not the country where the student is currently studying.

\*\* **These two documents must be sent by post to the SeoulTech Office of International Affairs no later than two weeks before student's arrival in Korea.**

### Language requirement

SeoulTech requires a good command of [English \(B2 level\)](#) or [Korean \(TOPIK Level 3\)](#) in order to communicate and function effectively in an academic environment.

An internationally recognized language certificate equivalent to the B2 level is required:

; TOEIC 750/ IELTS 5.5/ TOEFL 72 /Cambridge English Scale 160 / Global Scale of English (Pearson) 59

or

: Topik(Test of Proficiency in Korean) 3

\* Please note that students who apply to the exchange program using a TOPIK score will be permitted to enroll in Korean-language-taught courses only.

### Insurance

National Health Insurance is a mandatory program implemented by the Ministry of Health and Welfare in Korea and is not optional. It applies regardless of whether students have private insurance. Once foreign registration is completed after arrival in Korea, students' information will be updated in the National Health Insurance system, and students will be automatically enrolled.

As of 2026, the monthly National Health Insurance premium is KRW 79,310. A payment notice is sent each month to the student's registered residence in Korea.

### Visa

A student visa (D-2-6) is required for individuals who are not of Korean nationality in order to study in Korea. Please note that a visitor visa cannot be changed to a student visa within Korea. Students must apply for a D-2-6 student visa prior to arrival.

The Ministry of Justice introduced new regulations in June 2022 and strengthened immigration policies. As a result, additional documents are required for exchange students from non-OECD countries.

#### \* **Students from OECD countries**

Normally, the following three documents are sufficient to apply for a student visa (D-2-6):

- Certificate of Admission
- Letter of Acceptance
- Certificate of Business Registration

#### \* **Students from Non-OECD countries**

The Ministry of Justice has strengthened immigration policies and requires additional documents, even for exchange students.

- **Bank statement:** The statement must demonstrate sufficient funds to cover living expenses during the exchange period (USD 6,000 for one semester / USD 12,000 for one academic year).
- **Certificate of Enrollment:** This document must be apostilled or notarized by the Korean Embassy in the student's country of study.

※ These two documents must be sent by post to the SeoulTech Office of International Affairs no later than two weeks before student's arrival in Korea. If the documents are not received by then, your previously issued student visa may be cancelled upon SeoulTech's request.

※ Important Note on Nationality: > The classification of "OECD" or "Non-OECD" countries is based strictly on the student's nationality (as indicated on their passport), not the location of their home university. (Example) A Cambodia student studying at a university in the Germany is classified as a "Non-OECD" student.

### **Korean buddy program & International Student Club(ISC)**

ISC (International Student Club) is a student organization at SeoulTech that serves as a buddy program for international students. During their stay in Korea, exchange students are supported by ISC members to help make their campus life more enjoyable and enriching.

- \* **Instagram:** @isc\_seoultech

**SeoulTech Contact**

\* **Instragram: @seoultech\_internationalaffairs**

Exchange Student Coordinator	Name	E-mail
Outgoing (Coordinator for sending students to study abroad at SeoulTech)	Siyoon, Min	<b>exchange_seoultech@seoultech.ac.kr</b>
Incoming (Coordinator for accepting SeoulTech Partner Institution students )	Marina Mi ran PARK	
Short-term program	N/A	